

IP20

Faretto ad incasso a luce diretta con cornice a sezione tonda spessa 5mm in metallo verniciato bianco, nero, grigio o cromo lucido e spazzolato.

Recessed spotlight with direct light with a 5mm thick round section frame. Metal painted entirely white, black, grey and in polished or brushed chrome.

Plafón empotrado a luz directa, con cornisa a sección ronda de 5mm. De metal pintado totalmente de color blanco, negro, gris y de cromo cepillado o pulido.

TAU

CODICE CODE	DESCRIZIONE DESCRIPTION	DATI TECNICI TECHNICAL DATA	COLORI COLOURS
T010 AB	INCASSO 90°	Max 1x50W GU10	01 - 02 - 03 - 04 - 05
T010 BB	INCASSO 90°	Max 1x50W GU5.3 (12V) *	01 - 02 - 03 - 04 - 05

ACCESSORI
ACCESSORIES

CLASSE 1 IP23
 IP23

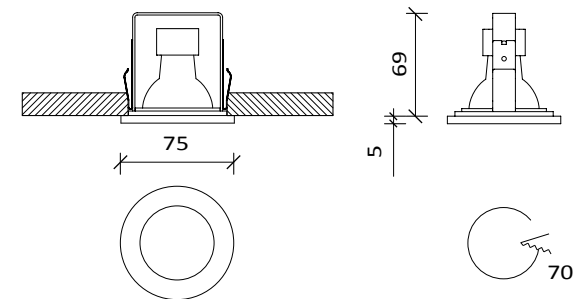

MINITAU

CODICE CODE	DESCRIZIONE DESCRIPTION	DATI TECNICI TECHNICAL DATA	COLORI COLOURS
T010 BC	INCASSO 90°	Max 1x35W GU4 (12V) *	01 - 02 - 03 - 04 - 05

ACCESSORI
ACCESSORIES

IP23

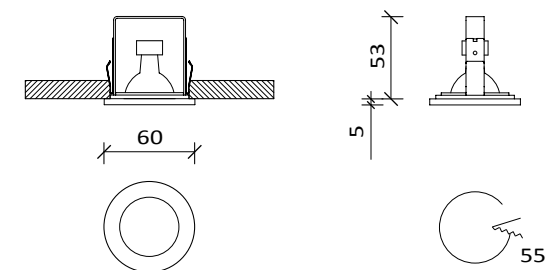

* Trasformatore non incluso
Transformer not included